

SPECIAL APPLICATION

SECURITY FITTINGS

The Davis range of security luminaires are designed for use in high abuse areas including prisons, detention cells & rehabilitation centres. They are available in both T8 & T5 models & are manufactured from a minimum of 1.2mm powder coated steel. The diffuser is a dual layer of 6mm high impact clear polycarbonate underlay with an acrylic prismatic overlay. The diffuser frames are secured to the body by lanyards. The frame is then fixed to the body with stainless steel Torx pin head or Hex pin head screws. The luminaires can be fitted with night light facilities.



NORDUS SERIES

The Nordus is a vandal proof diffused security luminaire available in both recessed & surface mounted models. It is suitable for high security areas.

RECESSED PLASTER T8

Nordus Security Recessed Plaster

For recessed plaster ceilings. x designates diffuser overlay type Y5C, Y7C, K12C, K15C, K19C, K19TC silver tint. G12 for single layer PETG.

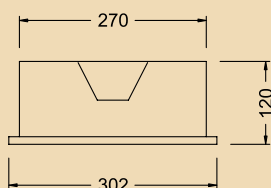
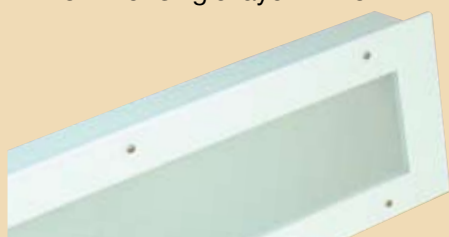

NOP218x	2/18w	695mm
NOP318x	3/18w	695mm
	Cut out size 665 x 275	
NOP236x	2/36w	1295mm
NOP336x	3/36w	1295mm
	Cut out size 1265 x 275	

SPECIAL APPLICATION

SECURITY FITTINGS *continued*

RECESSED PLASTER T5



Nordus Security Recessed Plaster

For recessed plaster ceilings. x designates diffuser overlay type Y5C, Y7C, K12C, K15C, K19C, K19TC silver tint. G12 for single layer PETG.

NOP214T5x	2/14w	695mm
NOP314T5x	3/14w	695mm
NOP224T5x	2/24w	695mm
NOP324T5x	3/24w	695mm
<i>Cut out size 665 x 275</i>		

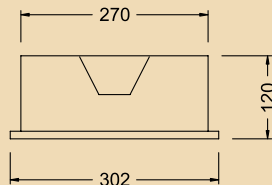

NOP228T5x	2/28w	1295mm
NOP328T5x	3/28w	1295mm
NOP254T5x	2/54w	1295mm
NOP324T5x	3/54w	1295mm
<i>Cut out size 1265 x 275</i>		

SURFACE MOUNTED T8

Nordus Security Surface Mounted

x designates diffuser overlay type Y5C, Y7C, K12C, K15C, K19C, K19TC silver tint. G12 for single layer PETG.

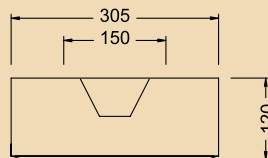

NOS218x	2/18w	640mm
NOS318x	3/18w	640mm
<i>Mountings 338 x 150</i>		
NOS236x	2/36w	1230mm
NOS336x	3/36w	1230mm
<i>Mountings 928 x 150</i>		



SURFACE MOUNTED T5

Nordus Security Surface Mounted

x designates diffuser overlay type Y5C, Y7C, K12C, K15C, K19C, K19TC silver tint. G12 for single layer PETG.

NOS214T5x	2/14w	640mm
NOS314T5x	3/14w	640mm
NOS224T5x	2/24w	640mm
NOS324T5x	3/24w	640mm
<i>Mountings 338 x 150</i>		

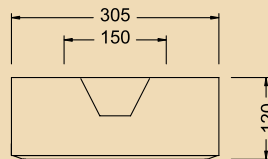

NOS228T5x	2/28w	1230mm
NOS328T5x	3/28w	1230mm
NOS254T5x	2/54w	1230mm
NOS354T5x	3/54w	1230mm
<i>Mountings 928 x 150</i>		



Compatible - see page 7 for options

T8 (26mm diameter) fluorescent lamp G13 lamp cap
 T5 (16mm diameter) fluorescent lamp G5 lamp cap

SPECIAL APPLICATION

SECURITY FITTINGS continued

SURFACE MOUNTED (CORNER) T8

Nordus Security Surface Mounted

x designates diffuser overlay type Y5C, Y7C, K12C, K15C, K19C, K19TC silver tint. G12 for single layer PETG.

NOC118x	1/18w	640mm
NOC218x	2/18w	640mm
NOC136x	1/36w	1230mm
NOC236x	2/36w	1230mm

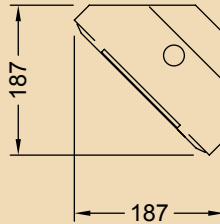

SURFACE MOUNTED (CORNER) T5



Nordus Security Surface Mounted

x designates diffuser overlay type Y5C, Y7C, K12C, K15C, K19C, K19TC silver tint. G12 for single layer PETG.

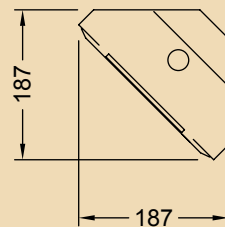

NOC114T5x	1/14w	640mm
NOC214T5x	2/14w	640mm
NOC124T5x	1/24w	640mm
NOC224T5x	2/24w	640mm
NOC128T5x	1/28w	1230mm
NOC228T5x	2/28w	1230mm
NOC154T5x	1/54w	1230mm
NOC254T5x	2/54w	1230mm